



**JOHN HALL & COMPANY**

LAND • COMMERCIAL • INVESTMENT PROPERTY

WWW.JOHNHALLCO.COM

Clark Gray

334.391.9249

Clark@johnhallco.com

## 76 Montana Drive

5.24 acres +/-  
Elmore County



**LOCATION:** 76 Montana Drive Titus, AL. Elmore County

**LAND USE:** Rural Residential / Mini Farm

**PRICE:** \$175,000

**SPECIAL FEATURES:** This property is conveniently located close to Lake Jordan. In a short 5-minute drive, Lake Jordan Marina is located 2.2 miles away. The property is only a 15-minute drive to downtown Wetumpka. There is approximately 440 feet of road frontage along Montana Drive. The 3 bedroom/ 2 bath modular home was built in 2018. It also has a 22' x 26' shop/ carport with power ran to it. This property is located within the Wetumpka School Zone district. This property is mostly wooded, however it has roughly a 3/4 AC fenced in pasture which would be great for a couple horses. With this property you can be out of the city and have your own mini farm in the country yet still close to the amenities of town. If you are interested in this property and would like to schedule a showing, contact me at 334-391-9249.

This company, or any of its agents, will not be held responsible for any false or misleading information. Information is collected by agents from sources that agent deems reliable. Agent has used his best efforts and good faith to obtain reliable information.

4163 CARMICHAEL ROAD | MONTGOMERY, ALABAMA 36106 | 334.270.8400

[www.JohnHallCo.com](http://www.JohnHallCo.com)







Titus 5 Ac  
Alabama, AC +/-

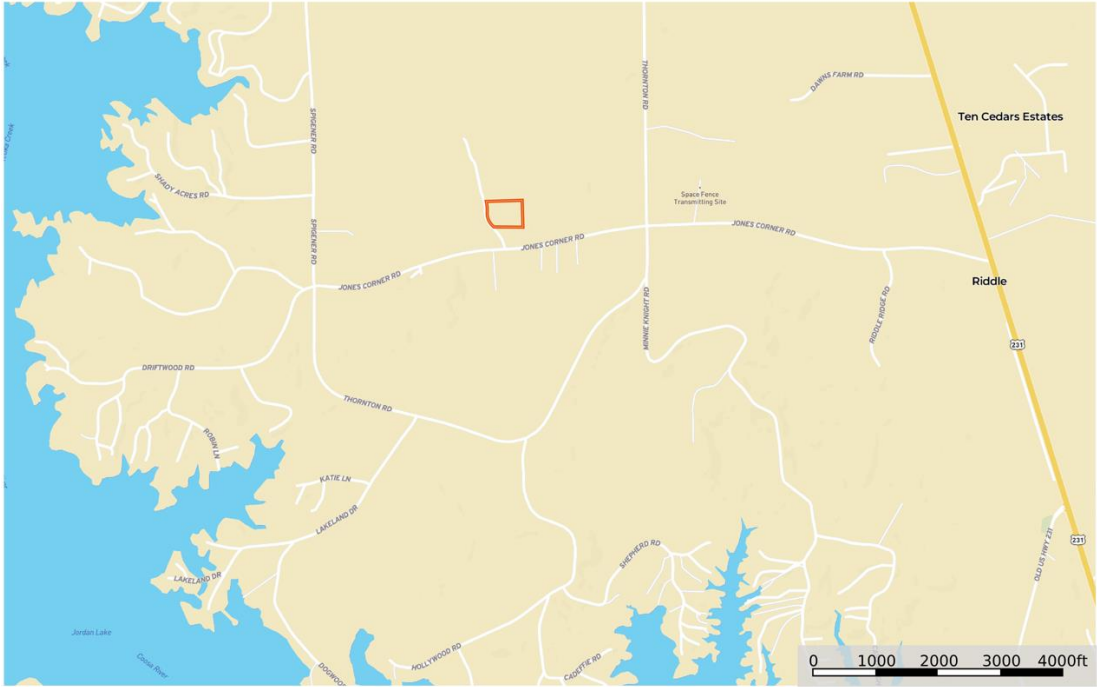

76 Montana  
Dr

Clark Gray  
P: 334-391-9249  
clark@johnhalco.com

**id.** The information contained herein was obtained from  
sources deemed to be reliable.  
Land id. Services makes no warranties or guarantees  
as to the completeness or accuracy thereof.









